

PLAT OF SURVEY

LOCATION: Wooddale Drive, Linn, Wisconsin

LEGAL DESCRIPTION: Lots 7,8,9,10,11 in Block 11 in WOODDALE ADDITION, according to the recorded plat thereof. Said land being in the Northeast 1/4 of the Northwest 1/4 of Section 16, Township 1 North, Range 17 East of the Fourth Principal Meridian, in the Town of Linn, County of Walworth, State of Wisconsin.

January 18, 2021 (Drawing Only)
January 28, 2021 Drawing Revised (Not Staked)

Survey No. 112218-S

March 5, 2021
Staked Prop. Dwelling



NOTE:
Boundary based upon survey
by Sattler Surveying, LLC.,
dated October 20, 2020.

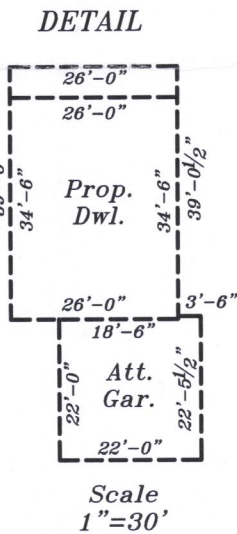

Prop. Gar. Slab
946.33'

Prop. T.O.W.
946.671

Prop. Fin. Yd. Gr.
946.0'

Proposed finished yard, 1st floor or top of foundation grade shown on this drawing is a suggested grade and should be verified by the owner, builder or municipality

METROPOLITAN SURVEY SERVICE, INC.

PROFESSIONAL LAND SURVEYORS

9415 West Forest Home Avenue, Suite 202
Hales Corners, Wisconsin 53130
PH. (414) 529-5380
survey@metropolitansurvey.com
www.metropolitansurvey.com

● — Denotes Iron Pipe Found
○ — Denotes Iron Pipe Set
000.0 — Denotes Proposed Grade
— — — — — Denotes Proposed Silt Screen

IW-60A2

